

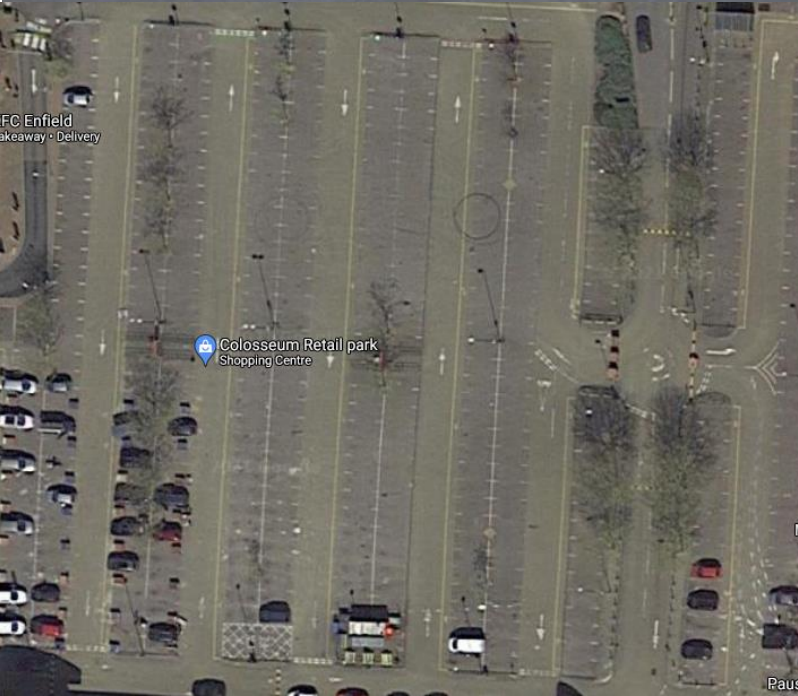

The countryside charity
London

Grey2Green

Alice Roberts, CPRE London, 20 May 2021



All roads lead to Rome...

1. Housing targets & pressure on space in London

Can we use grey space? Yes!

2. Lack of green space (London has only half the green space it needs)

Can we use grey space? Yes!

3. Healthier streets

Can we use grey space to shift away from car trips, reduce air and noise pollution, carbon emissions and road casualties, and increase active travel rates (walking & cycling). Yes, yes and yes!

4. “London's public realm has been deeply neglected for too long”

Can we use grey space to improve our public realm? Yes!

5. Managing climate change

Can we use grey space to help manage rain and temperature? Yes!

6. Visual amenity

Can we live in a park, rather than a car park? Yes!

...all point to the need for re-allocation of ‘grey’ space

Parking Transformed

From this...

Camden Council has announced it is turning Alfred Place into a park.

To this

Eight ways
to transform parking and make
London a better place



The countryside charity
London

Working for a greener city

Colosseum Retail Park in Enfield

From this...



To this



Proposals to transform the Colosseum Retail Park in Enfield, hitherto a large car park with 'big box' retail units.

Street parking can be transformed into new parks and safe play spaces.

London has just half the green space it needs for a population its size. Not all our streets are needed for parking or as through-routes for cars. Some residential streets, and also streets in central London, can be converted to attractive, green, traffic-free spaces for relaxation or play.



A street in Holland where parking spaces were removed to create a safe play space.

From this...



To this



In Lambeth, a section of road was turned into a play space and safe, attractive walking route.



Parking can be removed from one or both sides of a street to allow for widened pavements or for new cycle lanes to make walking and cycling safer and more pleasant.

Responding to the coronavirus crisis, researchers at UCL found that only 36% of London's pavements are wide enough for social distancing and said there is an urgent need to reallocate street space in London so everyone can use streets safely. But they also pointed out that the lack of space for walking and cycling is a long-term problem.

Left: Parking was removed from one side of West Bank in Hackney to create a safe route for cycling.



Making space for pedestrians: pavements can be widened if parking spaces are suspended and cordoned off.

Public realm schemes can see visitor or shopping attractions, or historic squares, transformed from car parks into attractive new public spaces.

There are many examples where removal of car parking has transformed public spaces in London, for example at Somerset House. So much more could be done, in particular to transform historic squares and settings to their former glory.

From this...



To this



Proposed improvements to Market Square in Enfield.

Things are moving fast...

...not necessarily in the right direction

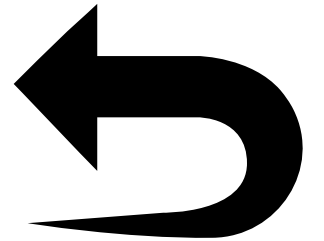
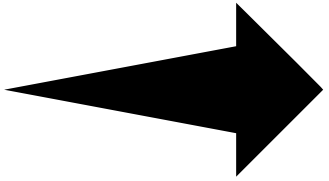



Vicarage Farm Vision

15 March 2021

VFV001

Vicarage Farm, Enfield



FARRELLS

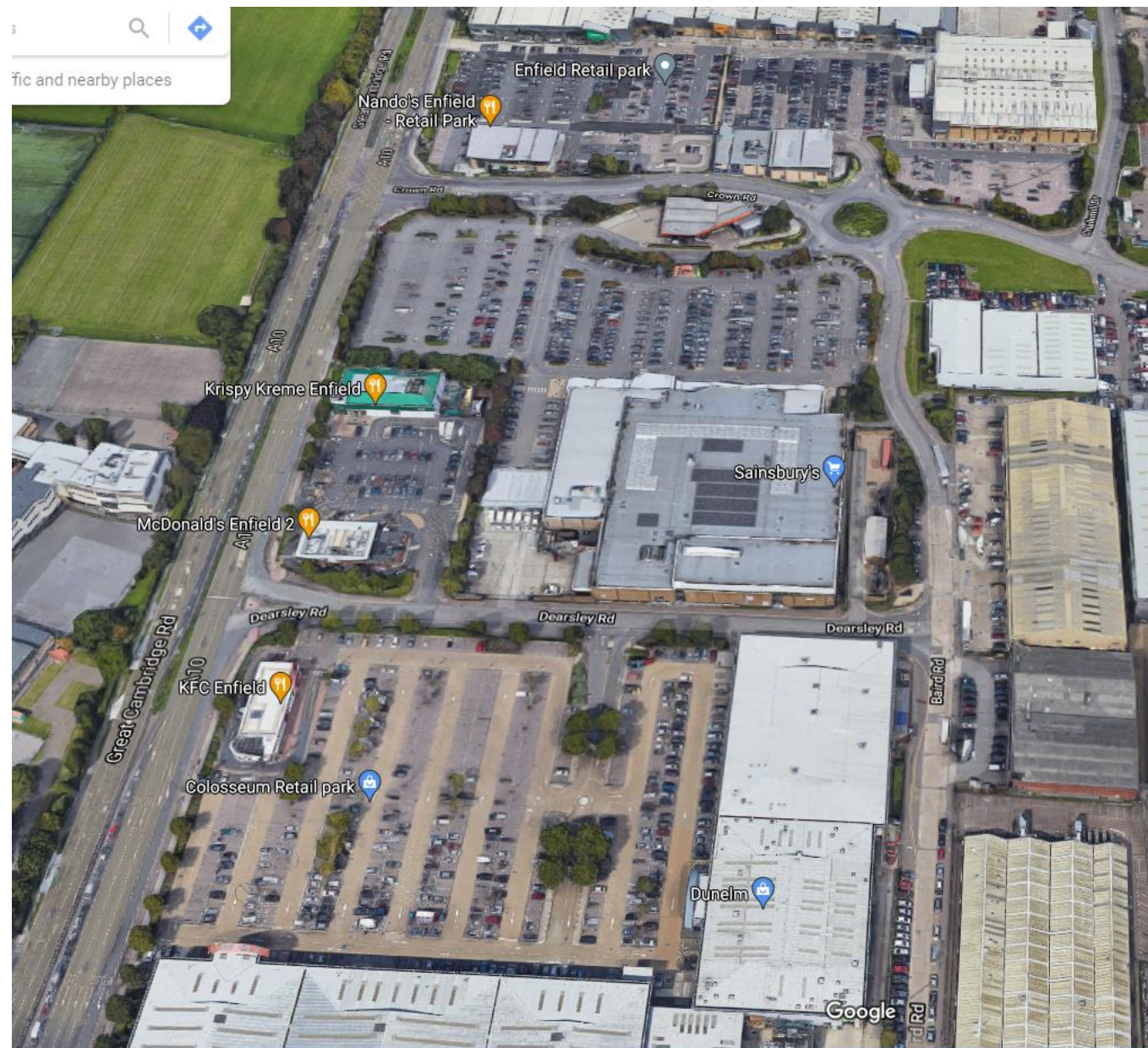







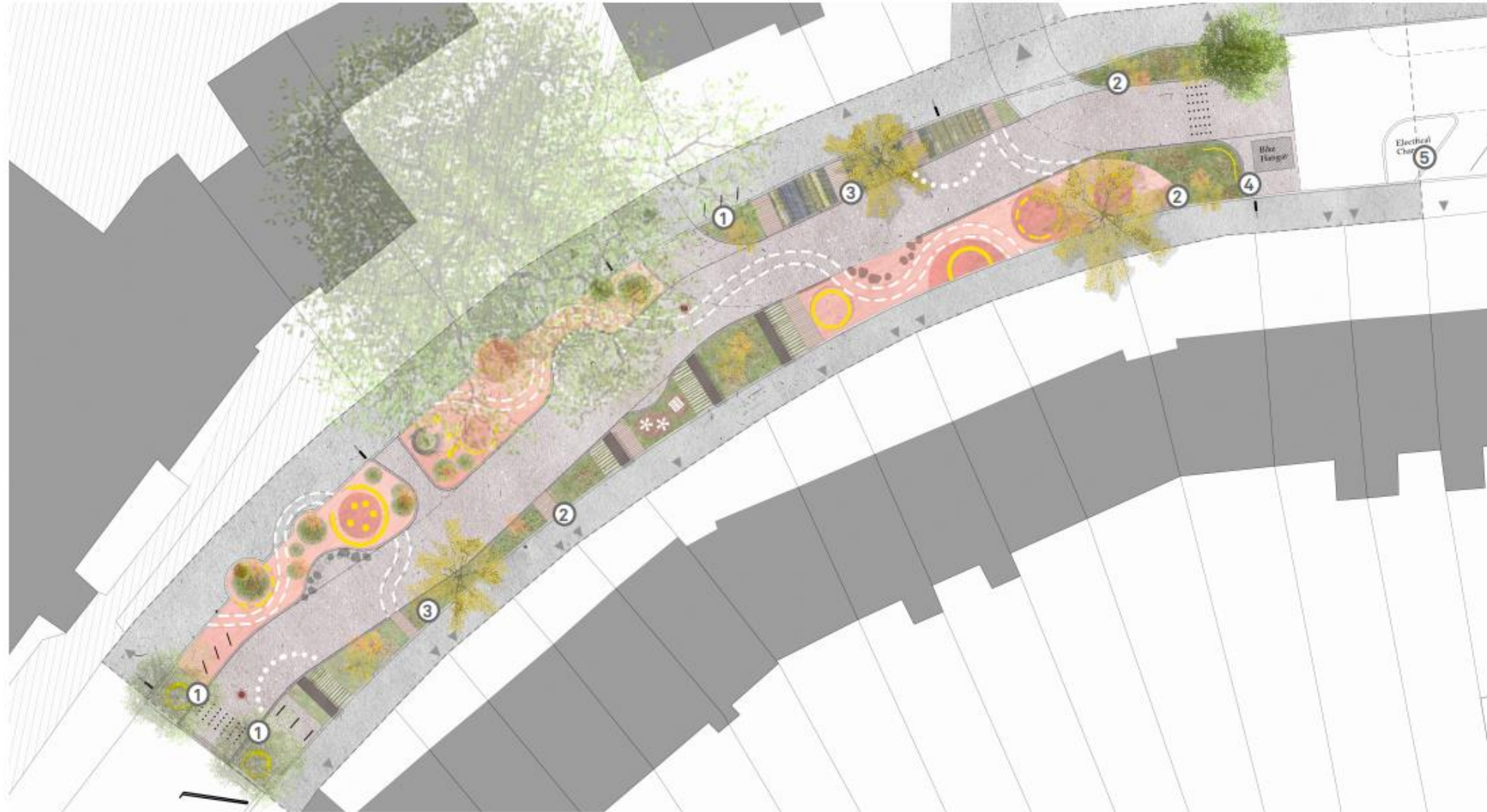

- ① New sheffield stands
- ② SUDs/ ecology planting
- ③ Proposed trees
- ④ Bike hanger
- ⑤ Electrical car charging points



The London Plan
identifies over
200 town centres;
could they all have
pedestrianised
high streets?

Credit @carfreedayLDN on Twitter



ESTABLISH A NETWORK
OF **TRAFFIC-
FREE TOWN
CENTRES
FOR LONDON**

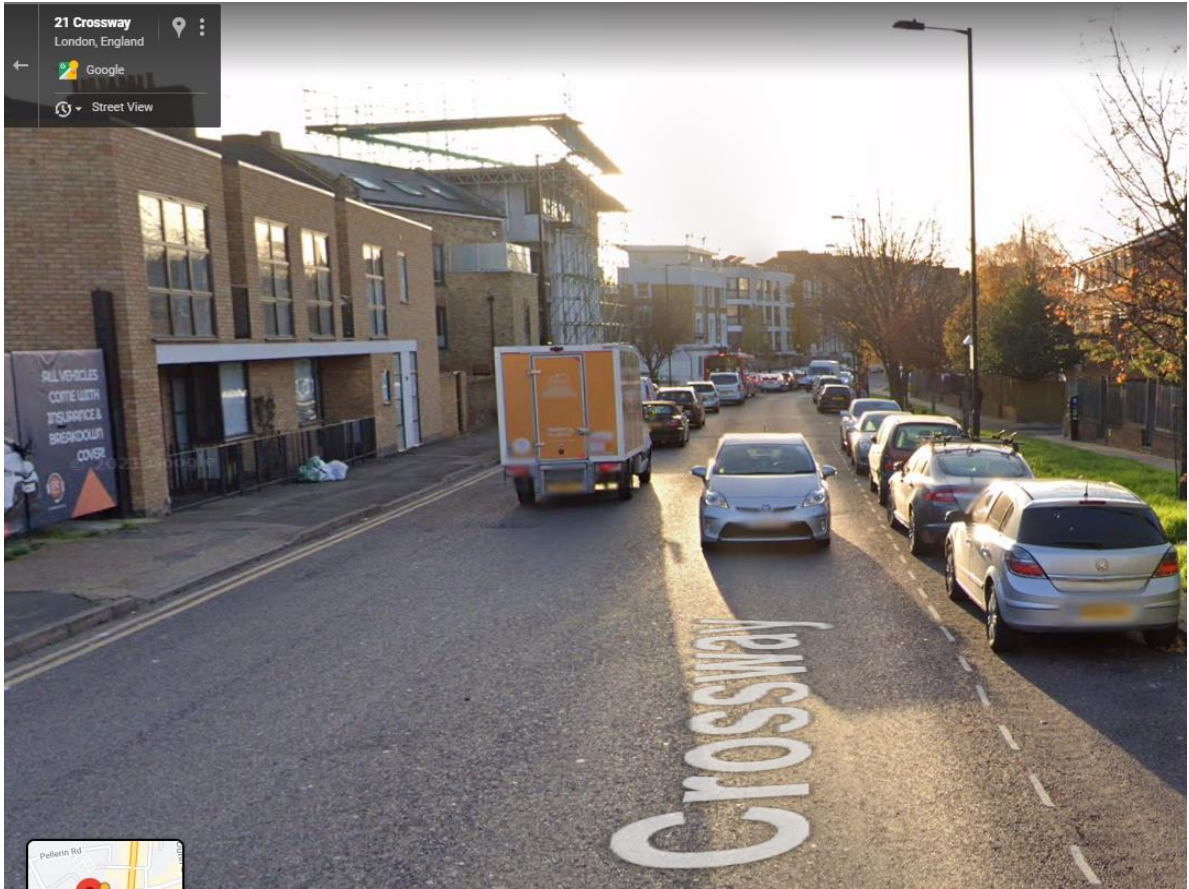



The countryside charity
London

Grey2Green

Challenge to one and all!

Credit @InfraCGI on Twitter



Credit @HackneyDownsLTN on Twitter

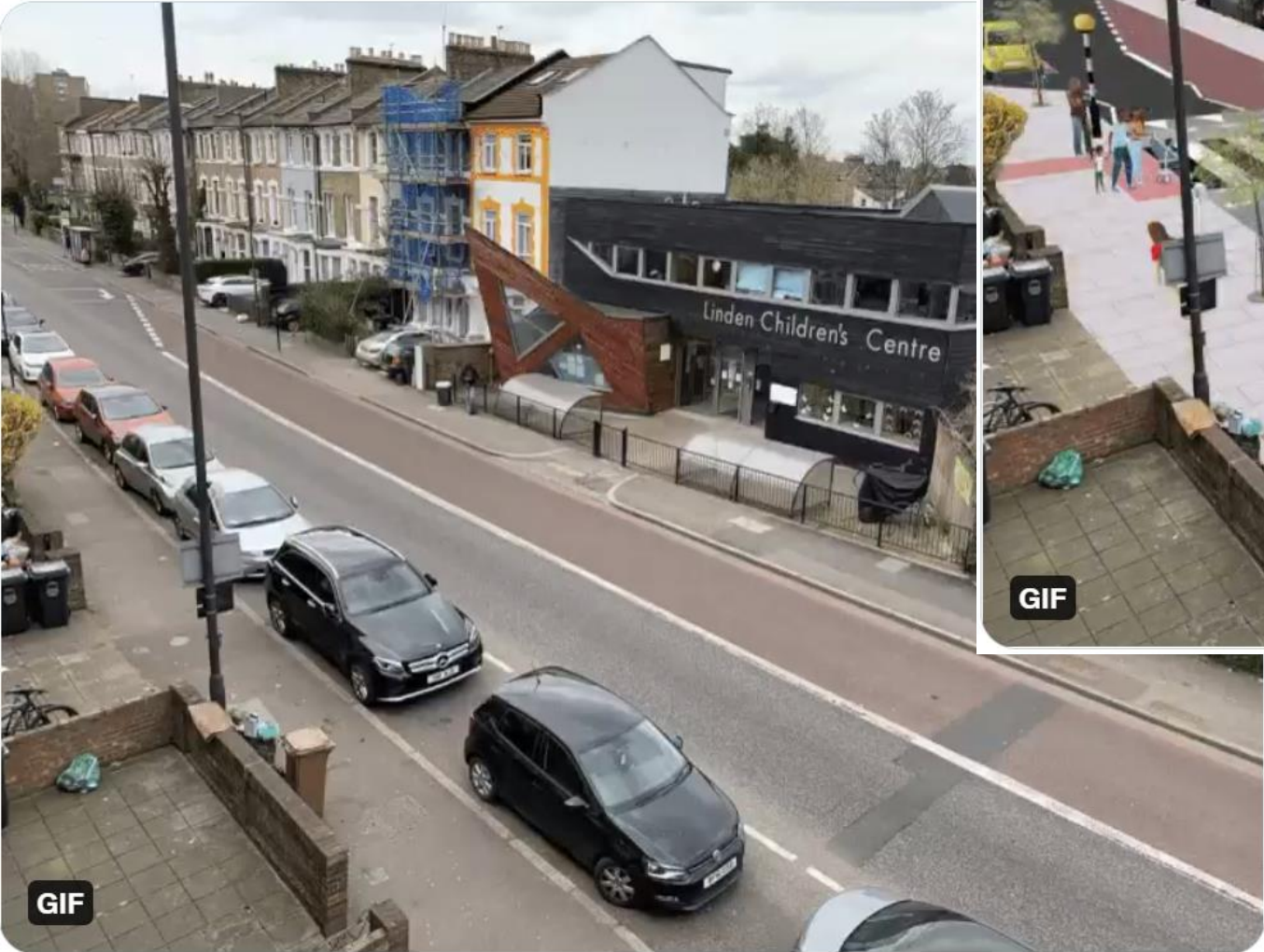

Credit Bromley Living Streets

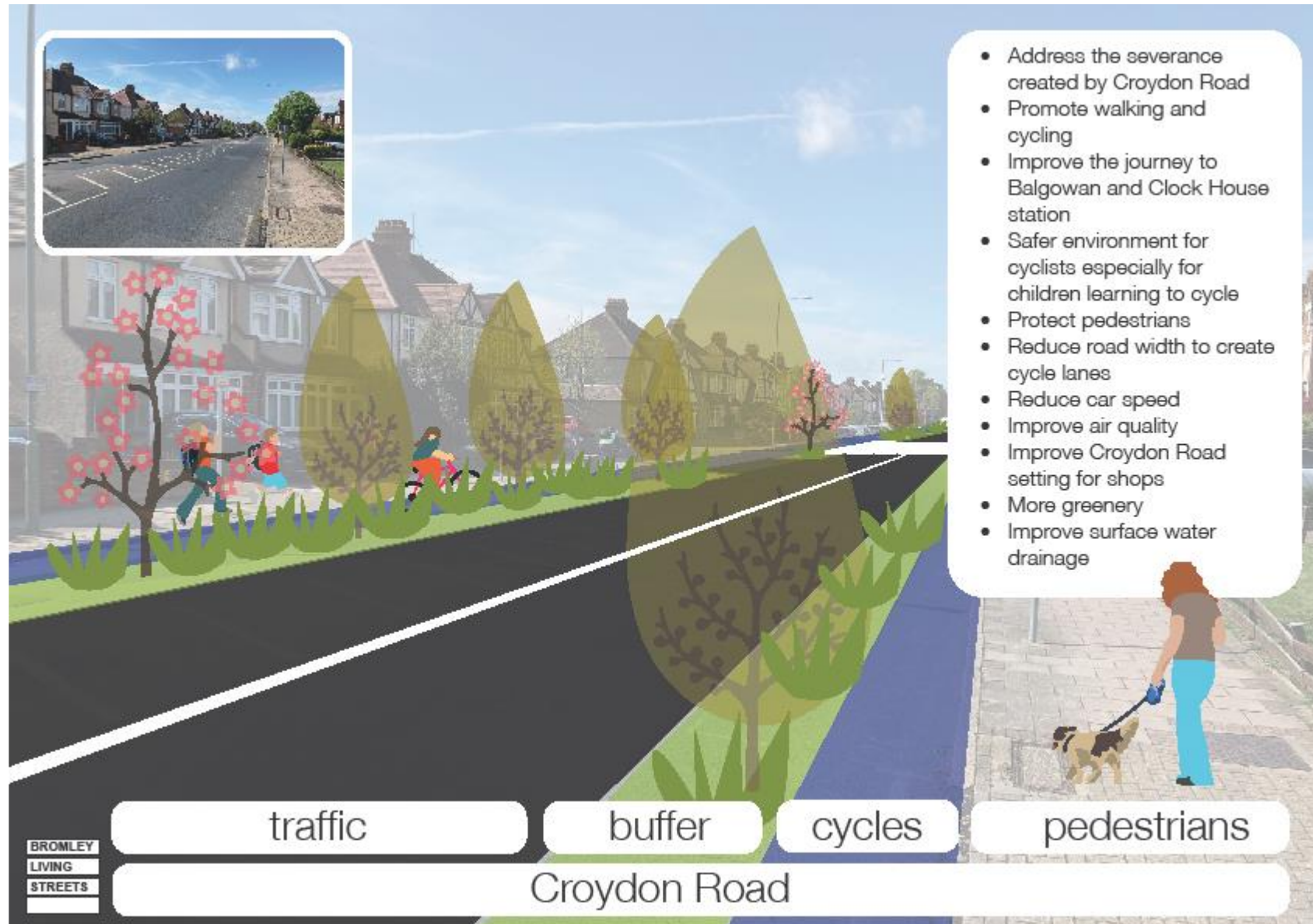







Call to action!



The countryside charity
London

Grey2Green



Credit Google Maps



Credit Google Maps

Google



Image: Google Maps

Google

Image <https://mapoflondon.uvic.ca/agas.htm>

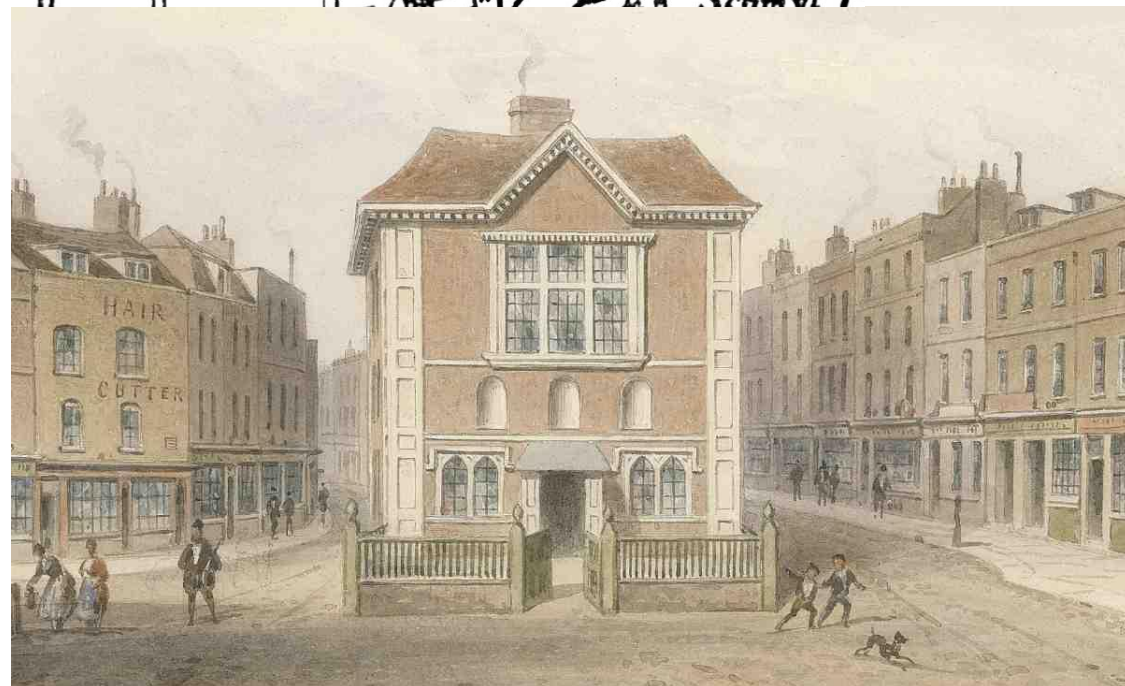

Image: <https://www.british-history.ac.uk/survey-london/vol46/pp203-221>

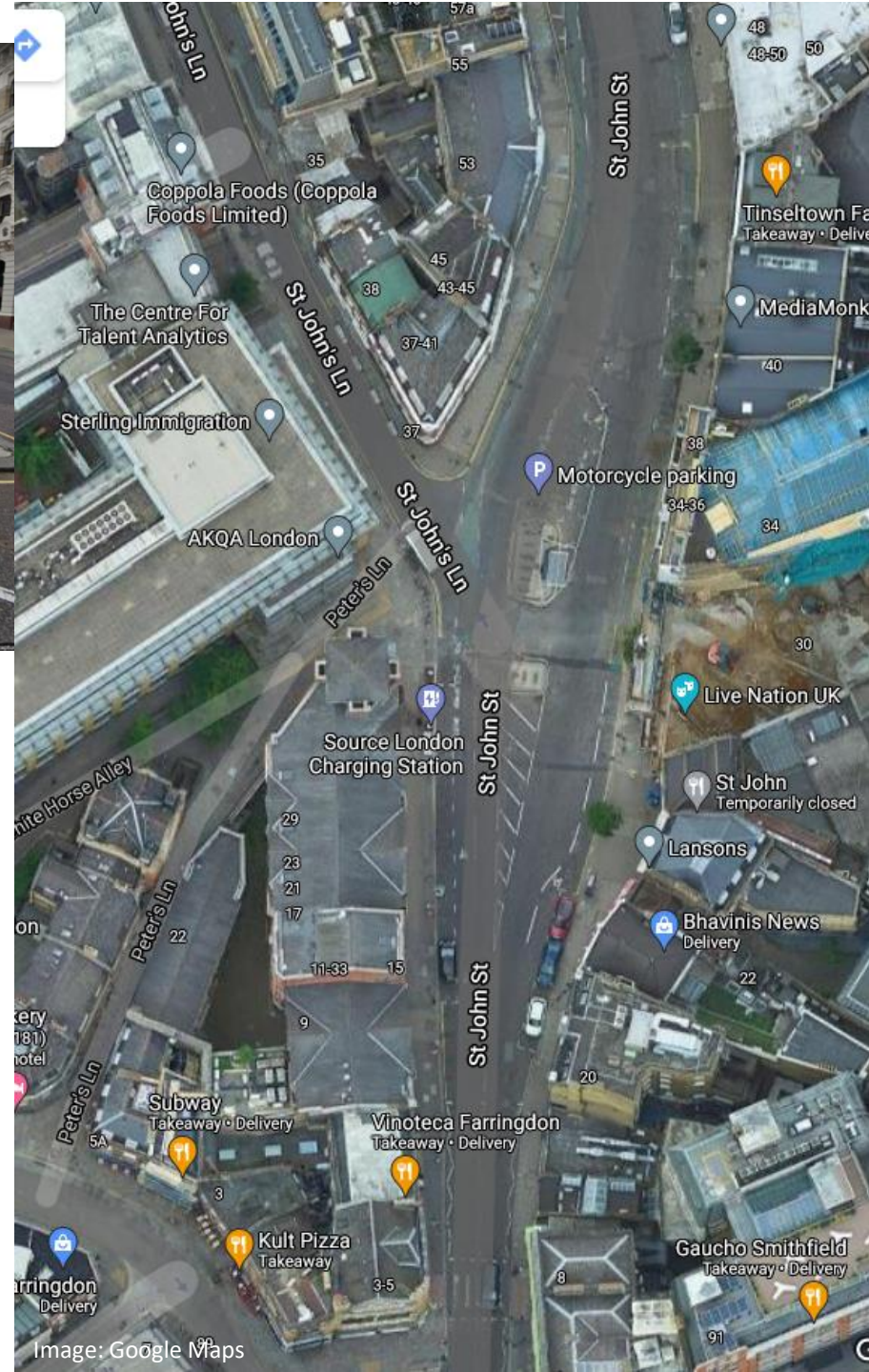
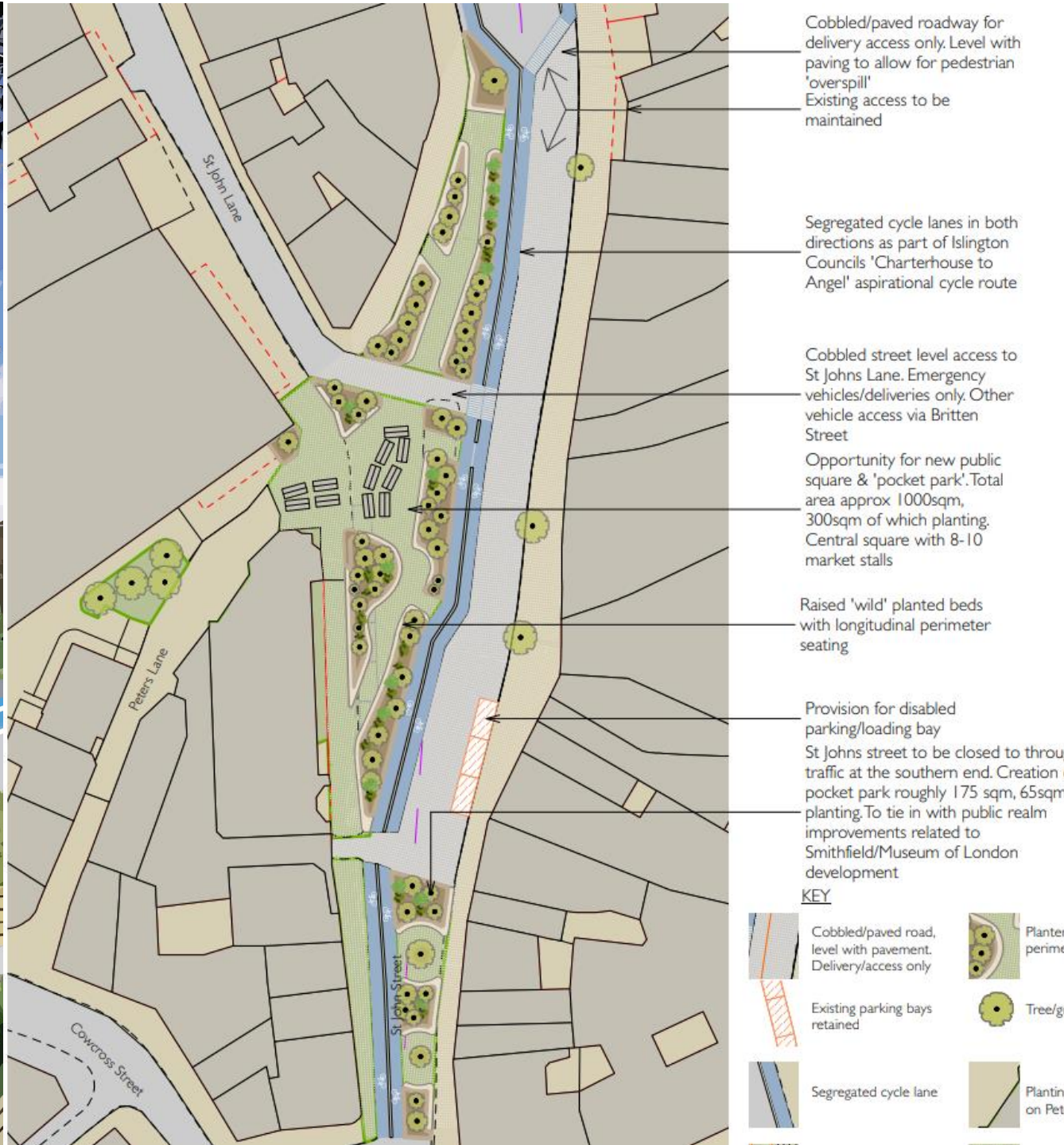

Image: Google Maps



Credit Alix Gunn, CPRE London volunteer and Urban Designer



Please propose changes to streets & town centres near you!

Local Elections May 2022 – all London boroughs

Contact us if you'd like help alice@cprelondon.org.uk



The countryside charity
London

Grey2Green